

Rockwood 320 Series Latch Protector

The global leader in
door opening solutions

For Installation Assistance, Call Rockwood Products at 800-458-2424 • www.rockwoodmfg.com

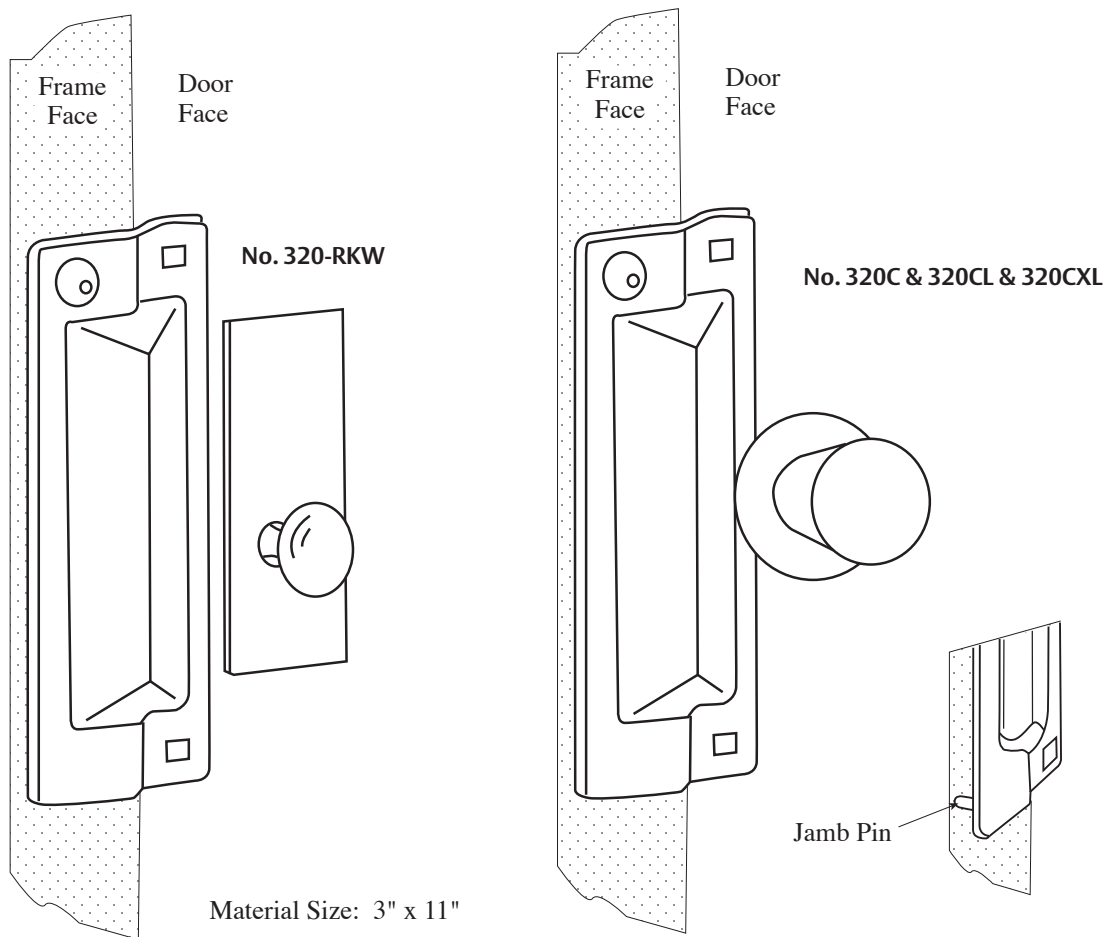

Material Size: 3" x 11"

1. Mark holes $\frac{7}{8}$ " from door edge.
2. Drill $\frac{5}{16}$ " holes through door.
3. Recessed cap nuts require $\frac{7}{16}$ " bore.
4. Tighten nuts with $\frac{3}{16}$ " hexagon wrench.
5. Drill face of frame for jamb pin

Reversible Unit.

NOT TO SCALE

300 Main Street
Rockwood, Pennsylvania 15557
P: 800.458.2424 | F: 800.922.9212
www.rockwoodmfg.com | orders.rockwood@assaabloy.com

Copyright © 2017, Rockwood Manufacturing Company, an ASSA ABLOY Group company. All rights reserved.
Reproduction in whole or in part without the express written permission of Rockwood Manufacturing Company is prohibited.